

RECINTO Nº 1

X	Y	X	Y	X	Y
1	530.523,06	4.674.269,67	40	531.504,80	4.677.154,74
2	530.484,67	4.674.371,58	41	531.210,13	4.676.181,05
3	530.512,71	4.674.513,58	42	531.206,91	4.676.178,02
4	530.499,46	4.674.523,18	43	531.201,73	4.676.168,73
5	530.476,04	4.674.538,70	44	531.172,06	4.676.139,06
6	530.477,48	4.674.558,24	45	531.165,85	4.676.107,57
7	530.461,06	4.674.584,98	46	531.159,00	4.676.059,00
8	530.451,50	4.674.609,56	47	531.155,64	4.676.056,81
9	530.410,98	4.674.598,74	48	531.137,45	4.675.963,64
10	530.402,00	4.674.599,00	49	531.140,00	4.675.969,00
11	530.377,00	4.674.603,00	50	531.135,90	4.675.965,76
12	530.373,00	4.674.610,00	51	531.124,45	4.675.897,73
13	530.388,00	4.674.624,00	52	531.145,00	4.675.888,00
14	530.398,00	4.674.641,00	53	531.137,00	4.675.848,00
15	530.415,00	4.674.696,00	54	531.135,00	4.675.754,00
16	530.398,00	4.674.710,00	55	531.127,00	4.675.662,00
17	530.390,00	4.674.715,00	56	531.387,00	4.675.658,00
18	530.343,00	4.674.673,00	57	531.393,85	4.675.657,89
19	530.335,00	4.674.670,00	58	531.411,15	4.675.618,33
20	530.285,00	4.674.679,00	59	531.402,93	4.675.613,76
21	530.244,00	4.674.767,00	60	531.406,42	4.675.609,89
22	530.214,00	4.674.891,00	61	531.365,00	4.675.588,00
23	530.206,00	4.674.938,00	62	531.295,00	4.675.526,00
24	530.183,00	4.675.016,00	63	531.357,00	4.675.428,00
25	530.162,00	4.675.046,00	64	531.308,00	4.675.342,00
26	530.166,00	4.675.048,00	65	531.191,00	4.675.316,00
27	530.221,00	4.675.538,00	66	531.174,00	4.675.301,00
28	530.270,00	4.675.597,00	67	531.185,14	4.675.291,61
29	530.439,00	4.675.732,00	68	531.173,80	4.675.274,44
30	530.564,00	4.675.890,00	69	531.240,91	4.675.274,80
31	530.675,45	4.675.878,85	70	531.219,00	4.675.103,00
32	530.825,92	4.676.641,09	71	531.151,59	4.675.108,39
33	530.837,80	4.676.899,65	72	531.139,85	4.675.103,76
34	530.843,13	4.676.899,16	73	531.139,56	4.675.099,46
35	530.977,70	4.677.380,90	74	531.135,48	4.675.087,62
36	531.140,22	4.677.522,78	75	531.130,86	4.675.080,16
37	531.243,64	4.677.502,35	76	531.129,46	4.675.078,73
38	531.330,30	4.677.485,24	77	531.122,07	4.675.071,26
39	531.499,21	4.677.280,60	78	531.115,18	4.675.061,48

RECINTO Nº 2

X	Y	X	Y
79	531.070,26	4.675.076,67	
80	531.059,94	4.675.080,16	
81	531.058,23	4.675.071,69	
82	531.056,62	4.675.063,82	
83	531.055,78	4.675.059,31	
84	531.055,56	4.675.054,54	
85	531.053,26	4.675.055,50	
86	531.046,80	4.675.058,13	
87	531.042,93	4.675.059,23	
88	531.013,64	4.675.071,62	
89	531.007,50	4.675.071,78	
90	530.991,24	4.675.056,44	
91	530.977,36	4.675.039,30	
92	530.962,32	4.675.023,46	
93	530.950,28	4.675.014,62	
94	530.962,52	4.675.009,27	
95	530.981,18	4.675.000,94	
96	531.000,98	4.674.998,70	
97	531.000,21	4.674.995,29	
98	530.998,88	4.674.989,36	
99	530.996,28	4.674.977,68	
100	530.992,75	4.674.977,41	
101	530.990,96	4.674.977,28	
102	530.989,58	4.674.965,54	
103	530.965,00	4.674.971,00	
104	530.946,00	4.674.960,00	
105	530.963,00	4.674.958,00	
106	530.954,35	4.674.888,74	
107	530.944,86	4.674.885,88	
108	530.923,08	4.674.876,74	
109	530.917,31	4.674.873,48	
110	530.921,69	4.674.869,98	
111	530.866,51	4.674.590,27	
112	530.845,18	4.674.594,48	
113	530.813,80	4.674.435,41	
114	530.812,22	4.674.427,43	
115	530.801,28	4.674.426,37	
116	530.761,05	4.674.222,67	
1	530.523,06	4.674.269,67	

RECINTO Nº 3

X	Y	X	Y
117	529.582,18	4.674.415,15	
118	529.588,33	4.674.404,06	
119	529.589,79	4.674.510,61	
120	529.642,89	4.674.507,36	
121	529.698,89	4.674.505,03	
122	529.696,76	4.674.480,73	
123	529.695,51	4.674.474,37	
124	529.684,92	4.674.438,52	
125	529.683,62	4.674.419,44	
126	529.670,75	4.674.418,32	
127	529.670,44	4.674.412,25	
128	529.696,12	4.674.412,25	
129	529.696,18	4.674.412,47	
117	529.582,18	4.674.415,15	

RECINTO Nº 4

X	Y	X	Y
156	532.809,03	4.685.393,61	
157	532.815,18	4.685.406,28	
158	532.829,07	4.685.400,75	
159	532.821,98	4.685.386,62	
160	532.820,97	4.685.387,33	
161	532.819,44	4.685.384,14	
162	532.809,03	4.685.393,61	

RECINTO Nº 5

X	Y	X	Y
162	532.881,39	4.685.701,55	
163	532.882,61	4.685.704,07	
164	532.883,61	4.685.702,28	
165	532.883,70	4.685.717,72	
166	532.884,00	4.685.724,32	
167	532.884,17	4.685.731,29	
168	532.884,67	4.685.742,00	
169	532.886,50	4.685.745,00	
170	532.888,34	4.685.748,08	
171	532.900,05	4.685.755,30	
172	532.909,45	4.685.774,31	
173	532.920,14	4.685.774,49	
174	532.938,24	4.685.774,53	
175	532.947,61	4.685.774,48	
176	532.948,70	4.685.774,33	
177	532.965,14	4.685.772,39	
178	532.972,21	4.685.796,10	
179	532.986,90	4.685.792,37	
180	532.993,60	4.685.797,62	
181	533.000,95	4.685.790,46	
182	532.999,39	4.685.713,67	
183	532.995,81	4.685.710,04	
184	532.932,85	4.685.705,88	
185	532.913,08	4.685.700,97	
186	532.886,51	4.685.694,23	
187	532.884,07	4.685.697,90	
188	532.881,39	4.685.701,55	

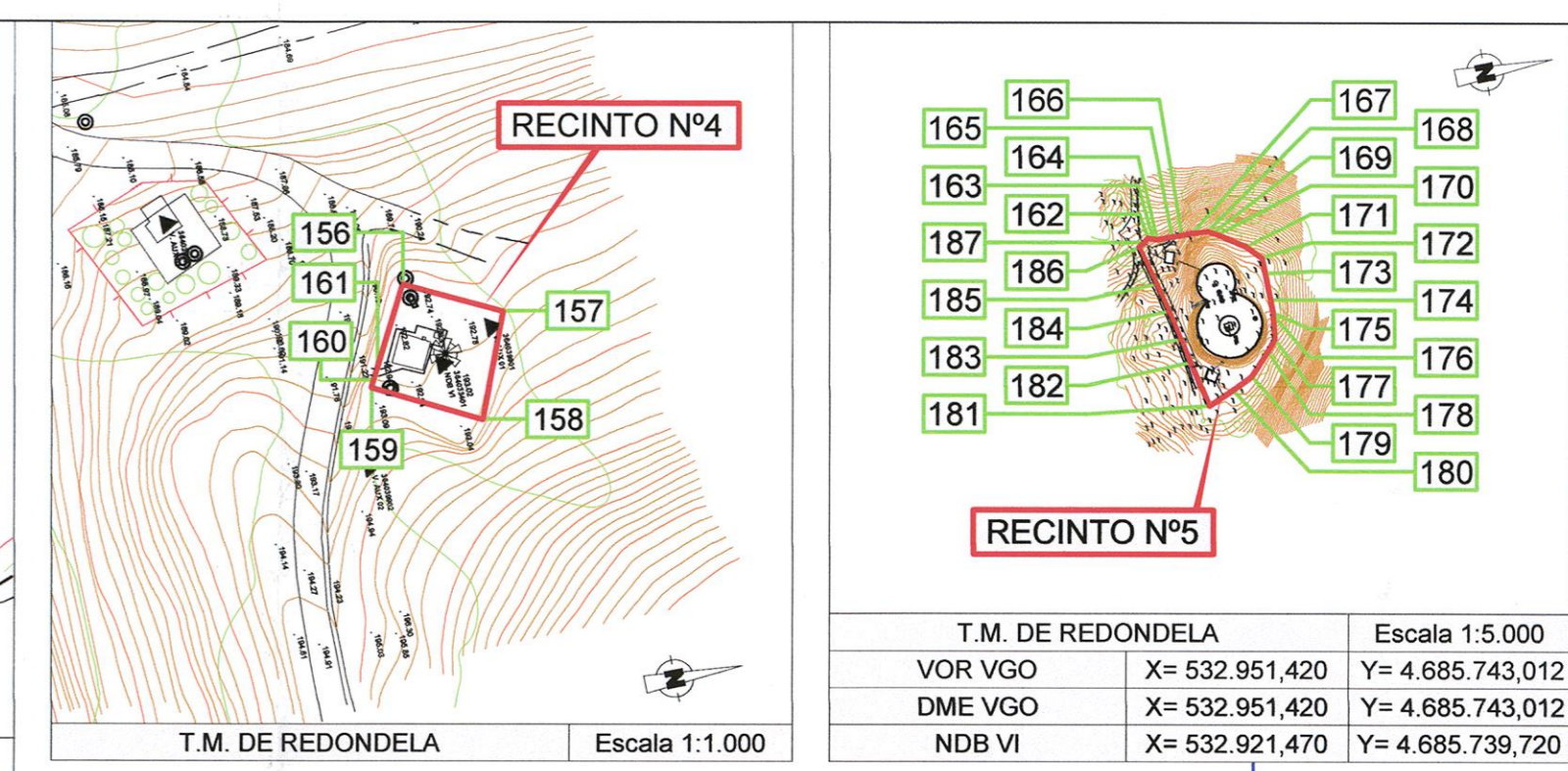

T.M. DE MOS Escala 1:5.000
 NDB VON X= 529.934,880 Y= 4.670.711,220

- LIMITE DE LA ZONA DE SERVICIO PROPUESTA
- AYUDAS RADIOELECTRICAS
- - - LIMITE MUNICIPAL

CARTOGRAFIA
 Coordenadas: UTM ED50
 Fuente: Aena
 Año: Enero 2004
 Escala: 1:5.000

NG	CONCEPTO	FECHA	POR
REVISIONES			
			DIRECCIÓN DE PLANIFICACIÓN DE INFRAESTRUCTURAS AEROPUERTO DE VIGO
CALCULADO DIBUJADO COMPROBADO PROYECTADO DIRIGIDO			
PLAN DIRECTOR			ZONA DE SERVICIO PROPUESTA COORDENADAS UTM
HOJA Nº	PLANO Nº	FECHA	
	4.4	MARZO 2010	1:5.000